

INTELLIGENT AUTOMATION AND LIGHT SOLUTIONS
FOR PATIENT ROOMS | GB

ESYLUX

PATIENT ROOM SETS ARE **ESY**, BECAUSE THEY SUPPORT HEALING PROCESSES

THE INTELLIGENT
AUTOMATION AND
LIGHT SOLUTION FOR
PATIENT ROOMS

ABOVE ALL IS HEALTH

THE PLUG-AND-PLAY SOLUTION FOR THE PATIENT ROOM

A pleasant ambience and trouble-free procedures in the daytime are just as important as silence and adequate orientation at night. Patient rooms are spaces in which to recover and at the same time to receive treatment; they require technical equipment that always focuses on people and healing processes. This can only be achieved to best effect through the synergy of demand-driven automation and intelligent lighting.

With its patient room sets, ESYLUX provides for patient rooms that are typically around 20 m² in size a pre-configured system solution that improves the atmosphere of a room fundamentally and comprehensively. It is able to do so thanks to what is known as human centric lighting that promotes a beneficial, invigorating and restful night's sleep, daylight-dependent adaptive HCL light control, and semi-automatic, presence-dependent light switching, which also keeps energy consumption to a minimum when rooms are not occupied. The push button allows patients and staff to manually override and access individual scenes at any time, for example for examination lighting at 1000 lux. At night, a gentle orientation light ensures a safe environment.

Planners and installers also benefit from our sets since they receive all of the individual components for a standard room under a single item number: LED lights, control units, sensory systems, push buttons and cables. Installation is performed via plug-and-play and does not require any programming effort; the system is ready for use immediately and is therefore suitable for rapid modernisation in a day-to-day use.

YOUR ADVANTAGES AT A GLANCE:

- Pre-configured, pre-finished complete solution for patient rooms
- Simple, quick and convenient installation through plug-and-play
- Healthy, beneficial light through SymbiLogic technology
- Daylight-dependent adaptive HCL light control
- Natural colour rendering (CRI>90) for optimal examinations
- Energy-efficient presence-dependent switching
- Pre-defined scenes for various treatment situations
- Scenes available at the push of a button
- Energy-efficient, low-maintenance LED lighting
- Future-proof technology with a 5-year warranty

ESYLUX SymbiLogic technology: presence- and daylight-dependent adaptive HCL light control.

- Proportion of artificial light
- ▨ Sufficient natural light
- Present
- Absent
- ⚕ Doctor/Nursing staff

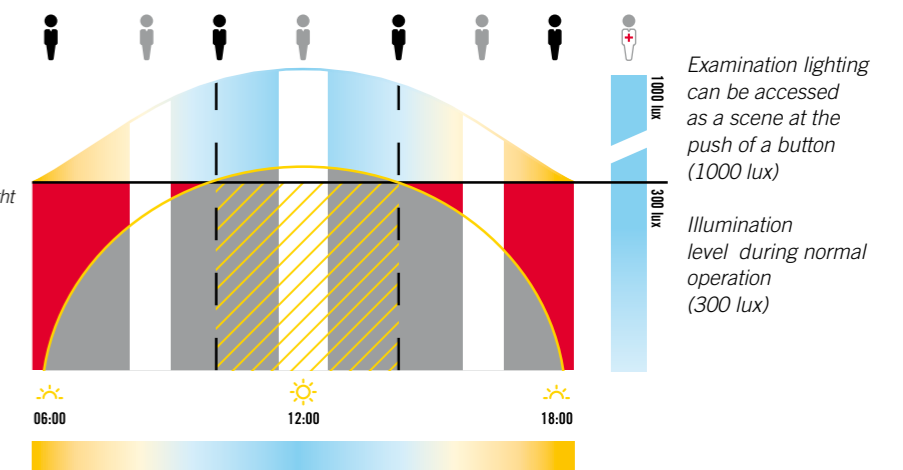

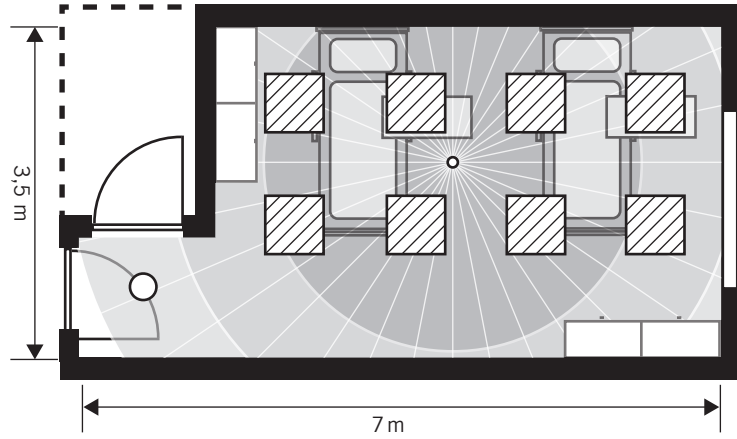

▲
 Planning example of the installation of patient room set 1 in a typical patient room 20 m² in size. The planning is designed for an illumination level of 1000 lux at a 1.10 m working height for examinations.



The light system used for the patient room set creates beneficial, energy-efficient human-centric lighting which, at the same time, allows the patient to sleep better at night thanks to integrated SymbiLogic technology. The push button allows the system to be adapted to different situations at any time, while a time-controlled night mode ensures a safe orientation light.

Patient room set 1	CELINE 600 IP54 CRI90 240W TW MILKY ELC PATIENT ROOM SET	EQ10129902
Patient room set 2	CELINE 625 IP54 CRI90 240W TW MILKY ELC PATIENT ROOM SET	EQ10129919

PRODUCT PACKAGES

PATIENT ROOM

Patient room set 1 consisting of:

	CELINE 600 IP54 CRI90 240W TW MILKY ELC PATIENT ROOM SET	EQ10129902
8x	CELINE 600 IP54 CRI90 30W TW MILKY ELC SATELLITE	EQ10129926
2x	ELC SmartDriver TW x4	EC10430572
1x	PD-C 360i/8 ELC	EP10427602
1x	Push Button 8x DALI PATIENT ROOM	EC10431265
1x	ELSA 225 18W 3000K MILKY DALI	E010300240

Patient room set 2 consisting of:

	CELINE 625 IP54 CRI90 240W TW MILKY ELC PATIENT ROOM SET	EQ10129919
8x	CELINE 625 IP54 CRI90 30W TW MILKY ELC SATELLITE	EQ10129933
2x	ELC SmartDriver TW x4	EC10430572
1x	PD-C 360i/8 ELC	EP10427602
1x	Push Button 8x DALI PATIENT ROOM	EC10431265
1x	ELSA 225 18W 3000K MILKY DALI	E010300240

FREELY CONFIGURABLE FOR ALL DIMENSIONS

In addition to the pre-configured, pre-finished sets for offices, classrooms and patient rooms, we also offer the option of compiling individual ELC solutions with system components and supplementary devices – for every application, every room dimension and every budget.

An overview of further intelligent automation and light solutions can be found at www.esylux.com

8x CELINE 600/600 (set 1) or
 CELINE 625/625 (set 2)

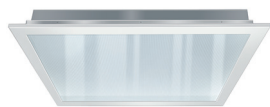

2x ELC SmartDriver TW x4



1x PD-C 360i/8 ELC
 (Presence detector)



1x DALI push button
 (DALI push button)



1x ELSA 225 18W 3000K
 MILKY DALI (downlight)



ESYLUX Deutschland GmbH

An der Strusbek 40
22926 Ahrensburg | Deutschland
t: +49 4102 489 0
f: +49 4102 489 333
info@esylux.de
www.esylux.de

ESYLUX Belgium nv

Vlamstraat 7 bus 2
9450 Denderhoutem-Haaltert | België
t: +32 53 850 570
f: +32 53 850 579
info@esylux.be
www.esylux.be

ESYLUX Danmark ApS

Kokholm 3A
6000 Kolding | Danmark
t: +45 76 72 90 90
info@esylux.dk
www.esylux.dk

ESYLUX France SARL

5 rue de Castiglione
75001 Paris | France
t: +33 1 5345 10 55
info@esylux.fr
www.esylux.fr

ESYLUX Nederland B.V.

Leeghwaterstraat 35
3364 AE Sliedrecht | Nederland
t: +31 184 647 000
f: +31 184 647 070
info@esylux.nl
www.esylux.nl

ESYLUX Norge AS

Strandveien 35
1366 Lysaker | Norge
t: +47 2255 52 00
f: +47 2255 52 01
info@esylux.no
www.esylux.no

ESYLUX Österreich GmbH

Hafenstraße 2A
4020 Linz | Österreich
t: +43 732 788 188 0
f: +43 732 788 188 7039
info@esylux.at
www.esylux.at

ESYLUX Portugal, Lda.

Lagoas Park Edifício 8, Piso 1
2740-244 Porto Salvo | Portugal
t: +351 214 236 170
f: +351 214 236 179
comercial@esylux.pt
www.esylux.pt

ESYLUX Russia

ООО "ИЗИЛЮКС РУ"
ул. Малая Калужская
д. 15, стр. 17 | эт. 3, оф. 541
119071 г. Москва | Россия
t: +7 495 782 72 40
info@esylux.ru
www.esylux.ru

ESYLUX Suomi Oy

Äyritie 12 B
01510 Vantaa | Suomi
t: +358 20 779 26 60
info@esylux.fi
www.esylux.fi

ESYLUX Sverige AB

Färögatan 33
164 51 Kista | Sverige
t: +46 470 853 00
f: +46 470 853 53
info@esylux.se
www.esylux.se

ESYLUX Swiss AG

Balz-Zimmermannstrasse 7
Postfach | 8058 Zürich-Flughafen | Schweiz
t: +41 44 808 61 00
f: +41 44 808 61 61
info@esylux.ch
www.esylux.ch

ESYLUX Asia Ltd.

No. 4 32/F Saxon Tower
7 Cheung Shun Street
Lai Chi Kok | Kowloon | Hong Kong
t: +852 3107 89 12
f: +852 3107 89 99
sales@esylux.com.hk
www.esylux.com.hk

ESYLUX GmbH (Export)

An der Strusbek 40
22926 Ahrensburg | Germany
t: +49 4102 888 80 0
f: +49 4102 888 80 441
sales@esylux.com
www.esylux.com

